

# GROUND FLOOR

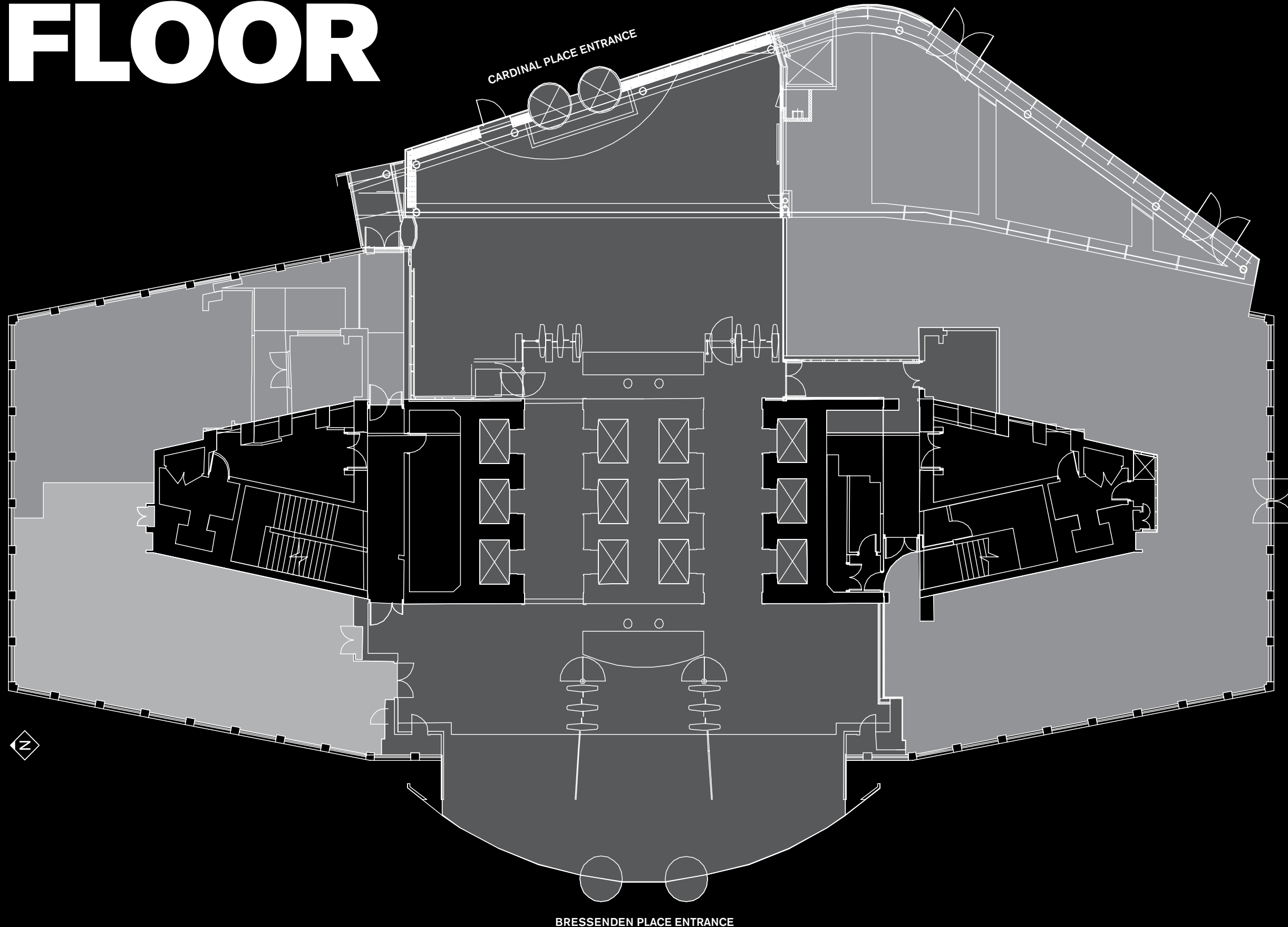

- Amenities:**
- Comfort cooling
  - Metal tiled suspended ceilings
  - Inset category II compliant lighting
  - Fully accessible raised floors
  - Male and female toilets on each floor
  - New high-speed passenger lifts
  - 24 Hour access and security
  - On-site management team
  - On-site gym facilities
  - On-site car parking and moped bays
  - On-site bicycle racks
- Reception  
■ Retail & Storage  
■ Management Suite  
□ Core Services